

Your New Address!

This is to inform you that Cypress County has implemented a **Municipal Addressing System**. Every residence will be assigned a unique address according to its access point on the Township/Range Road system. Starting this spring, County staff will be delivering a green and white sign to all ratepayers. The sign will come with a 2metre (6ft.) long mounting post and hardware. You are required to install this post and sign within 1 month of receiving it.

How it Works

- System is Access based.
Numbers increase going North and West.
- Odd numbers are on the South and East of roads.
- Even numbers are on the North and West of roads.
- There are generally 32 addresses per mile, of every township or range road, 16 on each side at 100 metre spacing.
- If two accesses fall within the same 100 metre zone they will be given letter designations, (ie: 12027A Rge. Rd. 61).

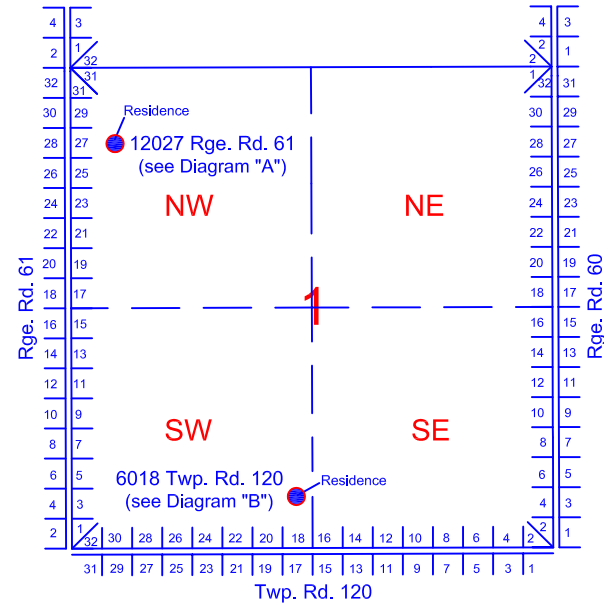

Diagram "A"

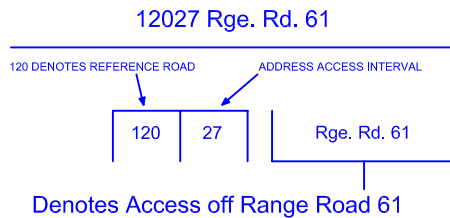
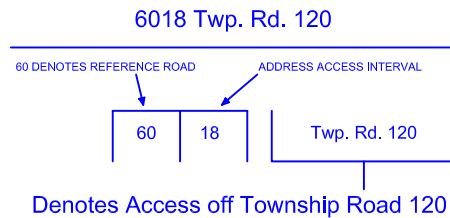

Diagram "B"



Mounting Your Sign

Diagram "C" shows the correct location of your sign. It should be placed on the right side of the main approach into the property, either in front of or attached to the main fence post approximately 1.2 metres (4ft.) above the ground. For your safety, please take the usual precautions before digging.

Diagram "C" : Sign Placement

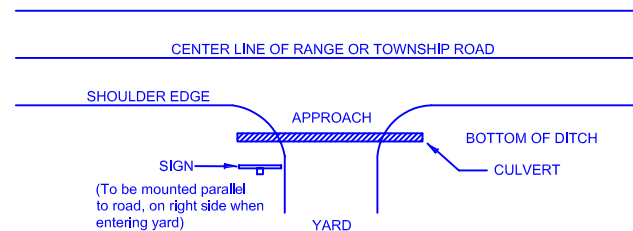

Your cooperation in this project is appreciated. If you have further questions, please contact the Cypress County Planning Department at (403)526-2888.